

Smart Positioner YT-2600

Product Number: YT-2600 ■ ■ ■ ■ ■ ■ ■ ■ (specify your requirement)

Model	Motion Type	Acting Type	Explosion Proof	Lever Type		Connection Type	Communication	Option *	Fail Option
				Linear	Rotary				
YT-2600	L Linear	S Single	C Ex d IIC T6	1 10~40mm	1 M6 × 34L	1 PT	0 NONE	0 NONE	F Fail Freeze S Fail Safe
	R Rotary	D Double		2 20~70mm	2 M6 × 63L				
				3 50~100mm	3 M8 × 34L				
				4 100~150mm	4 M8 × 63L				
						5 NAMUR			

* L/S: DC24V and Transistor Type Switch.

SIL2  



Item · Type	YT-2600L	YT-2600R
Input Signal	4~20mA DC	
Supply Pressure	0.14~0.7MPa(1.4~7 bar)	
Stroke	10~150mm	0 ~ 90°
Impedance	Max.460Ω @ 20mA DC	
Air Connection	PT(NPT)1/4	
Gauge Connection	PT(NPT)1/8	
Conduit	PF1/2 (G1/2)	
Repeatability	±0.3% F.S.	
Ambient Temp.	Operating Temp.	-30°C ~ 80°C (-22~176° F)
	Explosion Temp.	-40~70°C(T6) / -40~85°C(T5)
Linearity	±0.5% F.S.	
Hysteresis	±0.5% F.S.	
Sensitivity	±0.2% F.S.	
Air Consumption	0.01LPM (sup=0.14MPa)	
Flow Capacity	60 LPM (sup=0.14MPa)	
Output Characteristics	Linear, EQ%, Quick Open user set (16 Point)	
Material	Aluminum Diecasting	
Enclosure	IP66	
Explosion Proof type	Ex d IIC T6 / T5	
Weight	3.0kg (6.61lb)	

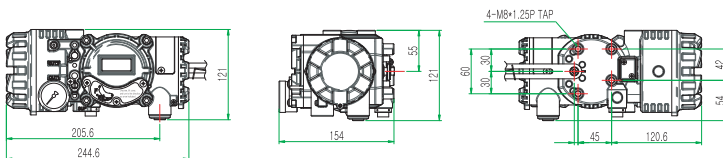

YT-2600 Smart Valve Positioner accurately controls valve stroke, according to input signal of 4-20mA being delivered from controller.

- Fail freeze function
- Near zero air consumption level
- HART communication
- Auto calibration
- PD control
- 4 buttons for local control
- LCD display
- Feedback signal
- Limit switches