



Clean Ball Valve

2013KB

1000 WOG

1/2" - 2"

ISO 5211 mounting

Cavity Filled RTFE Seats

Full bore

Tube Weld Ends

- Interior finish 20 Ra (180g)
- RTFE, PTFE Seats & PTFE Seals

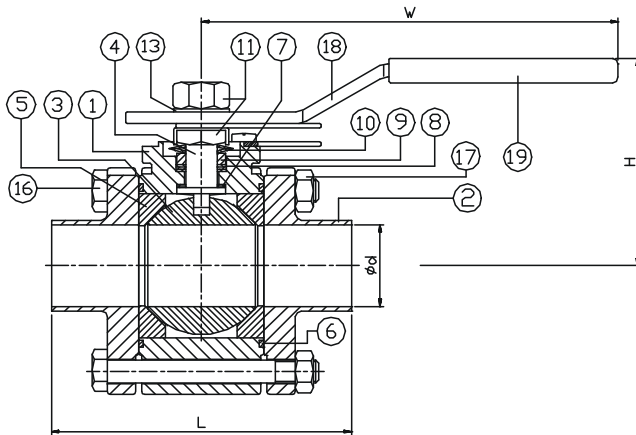
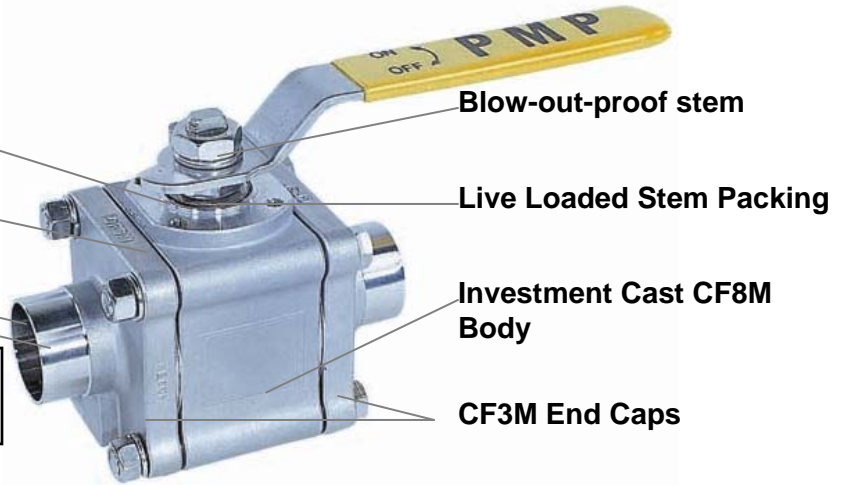

SIZE		1/2"	3/4"	1"	1-1/2"	2"
L	in	2.61	3.03	4.06	4.12	5.49
	mm	66.2	76.9	103	104.7	139.5
B	in	0.97	1.05	1.54	1.74	2.13
	mm	24.6	26.7	39.2	44.28	54
d	in	0.37	0.62	0.87	1.12	1.37
	mm	9.4	15.8	22.1	28.5	34.8
D	in	0.5	0.75	1	1.25	1.5
	mm	12.7	19.05	25.4	31.75	38.1
h1	in	1.56	1.61	2.31	2.47	3.06
	mm	39.5	41	58.7	62.85	77.8
H	in	2.11	2.17	2.59	2.80	3.18
	mm	53.5	55	65.8	71	80.8
W	in	4.50	4.50	5.75	5.75	7.00
	mm	114.3	114.3	146	146	177.8
d1	in	1.42	1.42	1.65	1.65	1.97
	mm	36	36	42	42	50
S	in	0.22	0.22	0.30	0.30	0.35
	mm	5.7	5.7	7.5	7.5	8.89

ITEM	PARTS	MATERIAL
1	BODY	CF8M
2	CAP	CF3M
3	BALL	CF8M
4	STEM	SS316
5	SEATS	RTFE
6	GASKET	PTFE
7	THRUST WASHER	PTFE
8	PACKING	PTFE
9	GLAND	SS304
10	DISC SPRING	50CrV4
11	STEM NUT	SS304
12	LOCK WASHER	SS304
13	WASHER	SS304
14	LOCK PAD	SS304
15	SCREW	SS304
16	BOLT	SS304
17	NUT	SS304
18	HANDLE	SS304
19	SLEEVE	PVC
20	STOP PIN	SS304

PMP Precision Valve Company Ltd. Is a progressive supplier of current products. The features, materials of construction and dimensional data as detailed in this bulletin are intended for your reference only, and should not be relied upon unless confirmed in writing by PMP Precision Valve Co. Ltd.. Certified dimensional drawings are available upon order receipt.

SIZE	1/2"	3/4"	1"	1-1/2"	2"
------	------	------	----	--------	----