



1 Piece Flanged Ball Valve – Regular Bore

M115

ANSI 150
1 1/2" – 12"



- Investment Cast CF8M Body 1/2"-6"
- Designed to: ANSI B 16.34, Class 150
- Flanged ends to ANSI B16.5
- Blow-Out Proof Stem
- Face to Face: ANSI B 16.10

Live Loaded Stem Packing *Keeps packing tight avoiding leaking valves and costly shutdowns or repairs.*

Locking Tab Washer

Keeps Lock nut from loosening in High Cycle Automated Applications

ISO 5211 Mounting Pad

Secondary Viton Stem Seal

Added backup seal for stem

Bi-Directional RPTFE Seats *for Bubble Tight Shut-Off*

Investment Cast CF8M Body

Polished Solid Stainless Steel Ball

Regular Bore

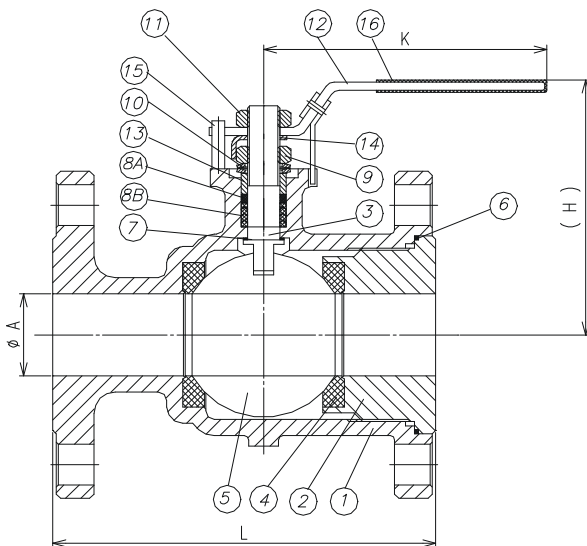

ITEM	PARTS	MATERIAL
1	BODY	CF8M
2	CAP	CF8M
3	STEM	SS316
4	SEATS	RPTFE
5	BALL	SS316
6	GASKET	RPTFE
7	THRUST WASHER	GRAPHITE
8A	PACKING	RPTFE
8B	PACKING	GRAPHITE
9	NUT	SS304
10	SPRING WASHER	SS301
11	NUT	SS304
12	HANDLE	SS304
13	GLAND	SS304
14	NUT LOCKER	SS304
15	STOP PIN	SS304
16	HANDLE GRIP	PVC

SIZE		1-1/2"	2"	2-1/2"	3"	4"	6"	8"	10"	12"
A	in	1.25	1.50	2.00	2.50	3.50	4.00	6.00	8.00	10.00
	mm	32	40	50	65	80	100	150	200	250
L	in	6.50	7.00	7.50	8.00	9.00	10.50	11.50	13.00	14.00
	mm	165	178	190	203	229	267	292	330	356
H	in	3.62	4.13	4.53	5.91	6.38	7.52	10.08	Gearoperator	
	mm	92	105	115	150	162	191	256		
K	in	7.87	9.45	15.75	15.35	15.35	15.35	25.59		
	mm	200	240	400	390	390	390	650		
Cv		120	240	400	360	690	990	2300	4000	7700